

RAD SAFETY ACCESSORIES

Ergonomics and safety are very important during the design phase of any new RAD tool. In addition to making the job more ergonomic and safe, we want our tools to be easy to use, powerful, accurate and very reliable. RAD believes safety features should not impede workplace efficiency and speed, but should make workers aware of the risks involved in working with powerful tools. RAD has developed a range of ergonomic and safety enhancing features.

Ergonomic features:

- RAD's patented planetary gear reduction drive system delivers 88 times less vibration than impact wrenches.
- No risk of HAVS injuries (Hand-Arm-Vibration-Syndrome). Lower risk than impact wrenches.
- Pistol grip trigger/control reduces operator error.
- RAD's low profile reaction arm eliminates all operational load on the operator.

Hand Guards



Trigger Guard



Reaction Arms

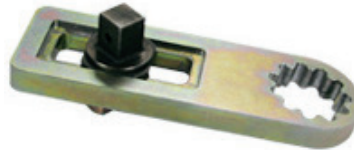

RAD REACTION ARMS

Each RAD tool includes a standard reaction arm. In addition to this, you can order the below special reaction arms to ensure correct reaction for different applications. Please consult our website for dimensions and part numbers.

Standard Reaction Arm



Deep Socket Reaction Arm

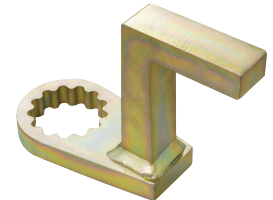

Double Ended Reaction Arm

